

Collection : Circé

Mitigeur d'évier 2 trous, bec mobile, avec douchette sur plan (V2) - 2-hole sink mixer, swivel spout, with handshower set (V2)

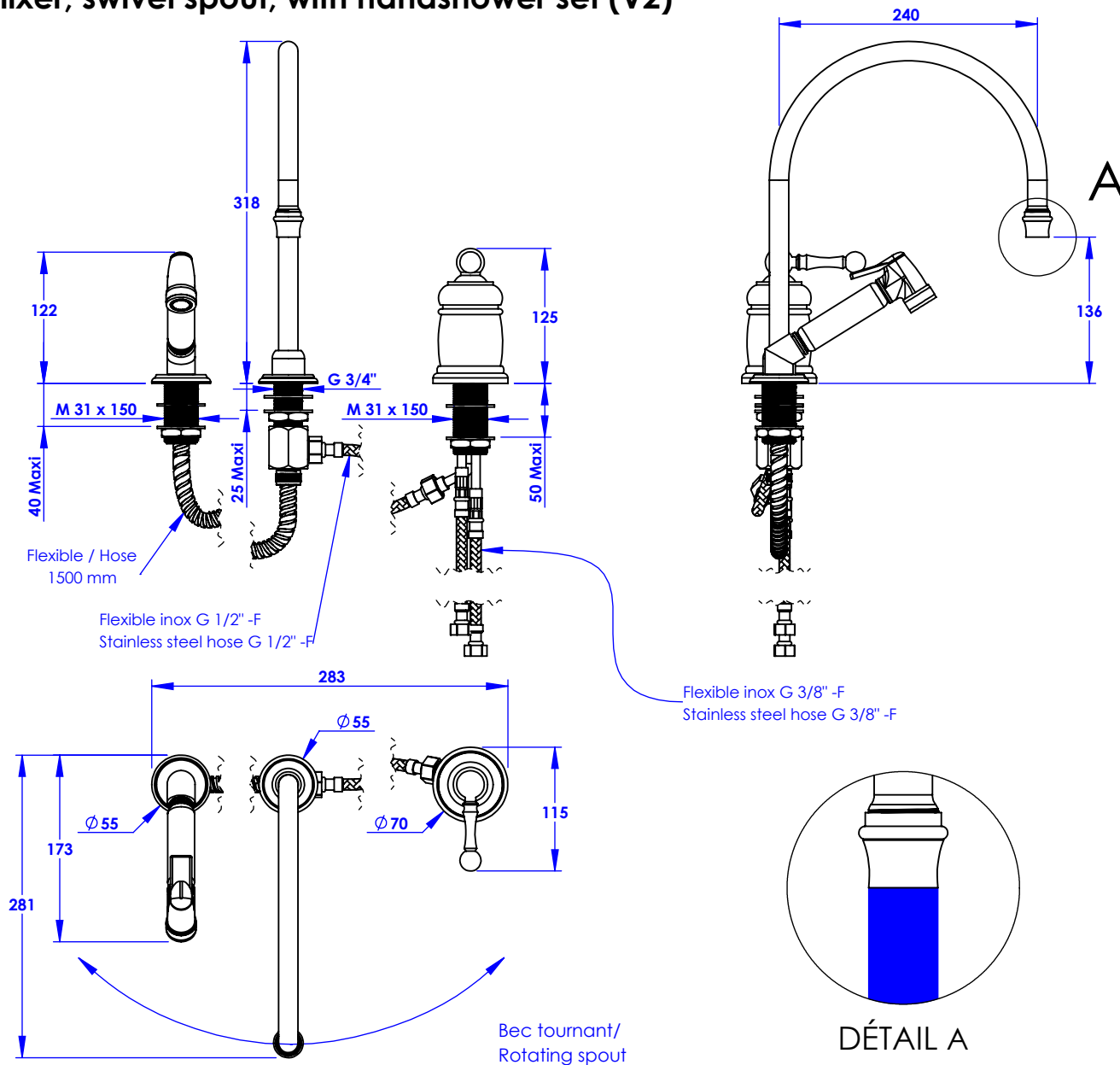

Ref : MK20-1102MBS



Débit douchette / Handshower flow rate : 12 l/min sous 3 bars.
Débit robinet / Faucet flow rate : 6 l/min sous 3 bars.
Pression maxi / max pressure : 5 bars.

Ø de perçage et entra-axe recommandés.
Ø Recommended drilling and centre distances.

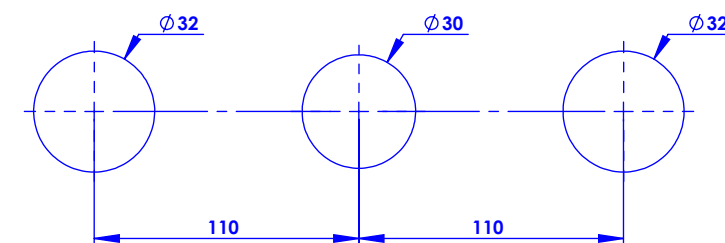

MARGOT

PARIS . 1912

03/11/2021 -1

Informations :

Raccordement par flexibles inox tressés (lg 350mm). / Connected by stainless steel hoses (lg 13"4/5).
Vidage non-fourni. / Waste not-included.